



Viva Decor
Creative Color Company

Beton zum Kneten

Concrete for kneading



INHALT

Table of Contents

- 3 Erste Schritte First steps
- 4-5 Schalen Bowls
- 6-7 Untersetzer „Nature Look“ Coasters “Nature Look“
- 8-9 Betonschilder Concrete Signs
- 10-11 Eulen Owls
- 12-13 Flaschen Bottles
- 14-15 Untersetzer Coasters
- 16-17 Pinnwand Magnete Magnet pins
- 18-19 Hase Rabbit
- 20-21 Kürbisse Pumpkins
- 22-23 Wichtel Gnome
- 24-25 Weihnachtsteller Christmas Plate
- 26-27 Weihnachtsschale Christmas Bowl

einfach - wie Ton - zu verarbeiten
easy to process, like clay

ohne Brennen „hart wie Stein“
“rock hard” without burning

wetter- und frostfest
weather- and frost-resistant

5 kg



1,5 kg



MATERIAL

MATERIAL

-Beton zum Kneten, 1,5 kg, Art. 9405 000 98
Concrete for kneading, 1,5 kg, Art. 9405 000 98

-Beton zum Kneten, 5 kg, Art. 9405 000 99
Concrete for kneading, 5 kg, Art. 9405 000 99

-Rührschüssel, *mixing bowl*

-Handschuhe, *Gloves*

-Messbecher, *Measuring cup*

-Küchenwaage, *Kitchen scales*

-altes Messer, *old knife*

-Silikonmatte, Art. 9302 063 00 oder Backpapier,
Silicone mat, Art. No. 9302 063 00 or baking sheet

-Speiseöl, *Cooking oil*



Arbeitsmaterialien lassen sich mit Leitungswasser **einfach** reinigen!

Working materials can **easily** be cleaned with tap water!

ERSTE SCHRITTE *First steps*

Informationen zum Mischverhältnis und zur Trocknungszeit sind dem Eimer-Etikett zu entnehmen.
Information regarding the mixing ratio and drying period are indicated on the bucket label.



1



2

Wasser einfüllen
Fill in the water



3

Betonpulver hinzugeben
Add the concrete powder



4

2 Min. rühren
Stir for 2 minutes



5

2 Min. ruhen lassen
Leave for 2 minutes



6

Nochmals durchrühren
Stir again



ZUSÄTZLICHES MATERIAL

ADDITIONAL MATERIAL

- Keramik Effekt, 150 ml, Art. 1185 100 48
Ceramic-effect, 150 ml, Art. 1185 100 48
- Multi-Color, 90ml, Schwarz, Art. 1223 800 11
Multi-Color, 90ml, Black, Art. 1223 800 11
- Premium Klarlack glänzend, 50 ml, Art. 1121 040 34
Premium Clear Coat glossy, 50 ml, Art. 1121 040 34
- Pinsel, flach, Größe 10, Art. 9300 110 00
Brush, flat, size 10, Art. 9300 110 00
- Pinsel, spitz, Größe 2, Art. 9300 162 00
Brush, pointed, size 2, Art. 9300 162 00
- Schleifpapier, Körnung 150, Art. 9300 917 00
Sanding Paper, 150 grit, Art. 9300 917 00
- Plastikschüssel / Plastic bowl
- Paketschnur / Package cord

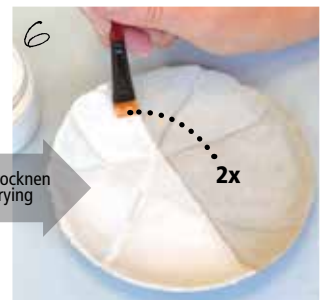

UNSER BETON "WIRFT SICH IN SCHALE"

Concrete bowls





ZUSÄTZLICHES MATERIAL

ADDITIONAL MATERIAL

- Maya-Gold, 50 ml,
Gold / Gold Art. 1232 902 34
- Rosé-Gold / Rose Gold Art. 1232 909 34
- Kakao / Cocoa Art. 1232 450 34
- Hämatit / Haematite Art. 1232 800 34
- Keramik Effekt, 150 ml, Art. 1185 100 48
Ceramic-effect, 150 ml, Art. 1185 100 48
- Premium Klarlack glänzend, 50 ml, Art. 1121 040 34
Premium Clear Coat glossy, 50 ml, Art. 1121 040 34
- Clear Stamps „Blätter“ Leaves Art. 4003 164 00
- Schleifpapier, Körnung 150, Art. 9300 917 00
Sanding Paper, 150 grit, Art. 9300 917 00
- Pinsel, flach, Größe 10, Art. 9300 110 00
Brush, flat, size 10, Art. 9300 110 00
- Pinsel, spitz, Größe 2, Art. 9300 162 00
Brush, pointed, size 2, Art. 9300 162 00
- Ausstecher rund Ø 10 cm / cookie cutter round Ø 10 cm

oder echte
Blätter
or real leaves

ca. 100g pro
Untersetzer
approx. 100g
per coaster



1



2

Stempel eindrücken
Impress clear stamp



3

Stempel sofort abziehen
Remove clear stamp immediately



4



5

Kanten glätten
smooth the edges



6

trocknen
drying

2x



7

anschleifen
grind it



8



9

lackieren
varnish it

2x

UNTERSETZER IM NATURE

Coasters in nature look

Look





ZUSÄTZLICHES MATERIAL

ADDITIONAL MATERIAL

- Keramik Effekt, 150 ml, Art. 1185 100 48
Ceramic-effect, 150 ml, Art. 1185 100 48
- Clear Stamps „Modern Alphabet“ Art. 4003 155 00
- Kreisausstecher Ø ca. 1,5 cm / *circle cutter Ø ca. 1,5 cm*
- Kreativ-Schwämmchen eckig / *Creative Sponge Square*
- Pinsel, spitz, Größe 2, Art. 9300 162 00
Brush, pointed, size 2, Art. 9300 162 00
- Holzstück mit Struktur / *structured piece of wood*
- Seil / *cord*

ca. 200g
"Welcome"

ca. 300g
"Lieblingsplatz"



ca. 15x11 cm

FINDE DEINEN Lieblingsplatz

Find your favorite place



ca. 20 x 14 cm

ZUSÄTZLICHES MATERIAL

ADDITIONAL MATERIAL

- Keramik Effekt, 150 ml, Art. 1185 100 48
Ceramic-effect, 150 ml, Art. 1185 100 48
- Tafel-Lack Schwarz, 250 ml, Art. 1271 800 50
Blackboard-Lacquer black, 250 ml, Art. 1271 800 50
- Modellier-Werkzeug, 6-tlg., Art. 9302 137 00
Modeling Tool Set, 6 pieces, Art. 9302 137 00
- Pinsel, flach, Größe 10, Art. 9300 110 00
Brush, flat, size 10, Art. 9300 110 00
- Pinsel, spitz, Größe 2, Art. 9300 162 00
Brush, pointed, size 2, Art. 9300 162 00
- Holzbox ca. 28 x 28 cm / wooden box ca. 28 x 28 cm
- Malerkrepp / Painter's tape
- Stück Ast / piece of branch
- Kreidestift / chalk pen
- Heißklebepistole / Hot glue gun

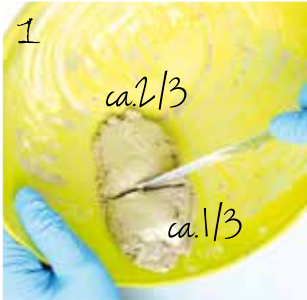

ALL YOU NEED IS LOVE...

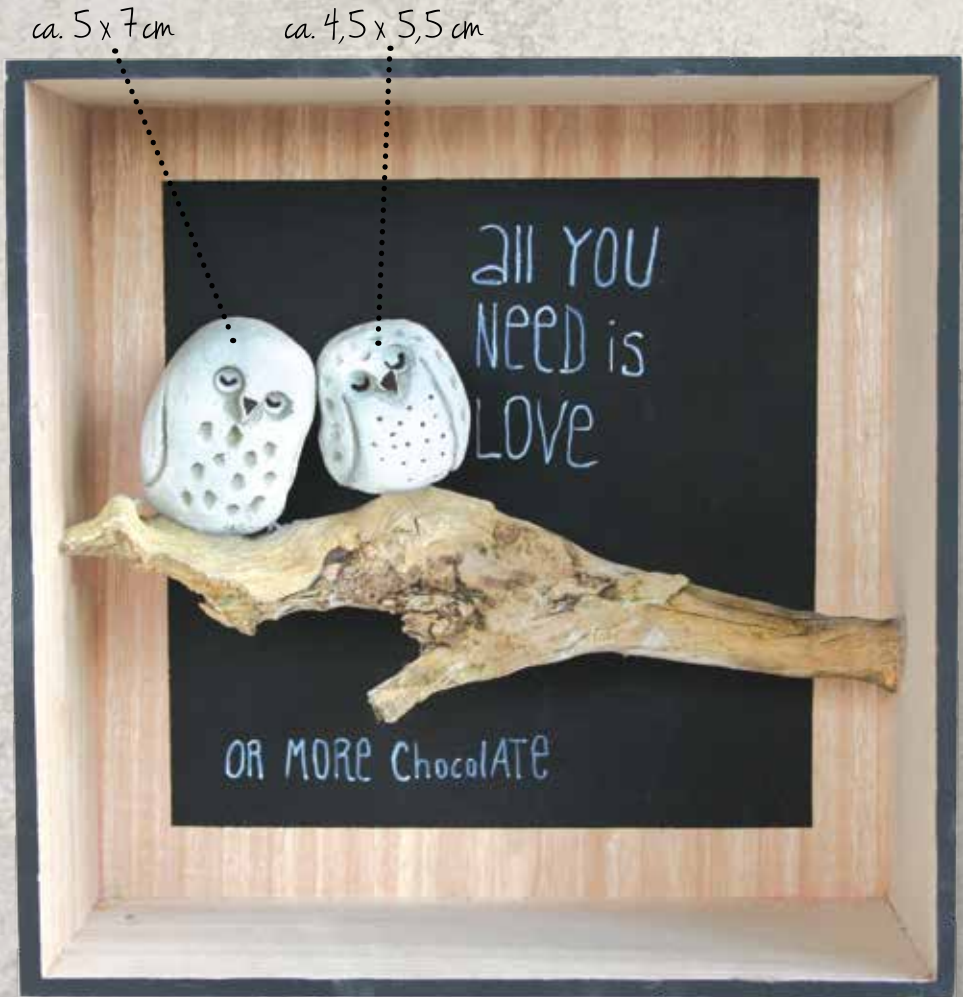



ZUSÄTZLICHES MATERIAL

ADDITIONAL MATERIAL

- leere Flaschen / empty bottles
- Maya-Gold, 50 ml,
Gold / Gold Art. 1232 902 34
- Clear Stamps „Sprüche I“ / Quotes / Art. 4003 142 00
- Pinsel, spitz, Größe 2, Art. 9300 162 00
Brush, pointed, size 2, Art. 9300 162 00
- gut strukturiertes Blatt / well structured leaf
- Heißklebepistole / Hot glue gun
- Bänder, Etikett, Federn / ribbons, tag, feathers

ca. 300g pro Flasche
approx. 300g per bottle



rollen+glätten
roll it + smooth it



Stempel eindrücken+ sofort
abziehen
Impress clear stamp+remove it
immediately



trocknen
drying

FLASCHEN im neuen GEWAND

Bottles with a new outfit





ZUSÄTZLICHES MATERIAL

ADDITIONAL MATERIAL

- Chalky Vintage Look, 250 ml,
Antikrosa / Antique Rose Art. 1196 402 50
Hellgrün / Light Green Art. 1196 701 50
- Maya-Gold, 50 ml,
Gold / Gold Art. 1232 902 34
- Clear Stamps „Alphabet modern“ Art. 4003 155 00
- Clear Stamps „Grafische Hintergründe“ / Graphic
backgrounds Art. 4003 161 00
- Ausstecher rund Ø 10 cm / cookie cutter round Ø 10 cm
- Pinsel, flach, Größe 10, Art. 9300 110 00
Brush, flat, size 10, Art. 9300 110 00
- Pinsel, spitz, Größe 2, Art. 9300 162 00
Brush, pointed, size 2, Art. 9300 162 00



Let's have a drink together





ZUSÄTZLICHES MATERIAL

ADDITIONAL MATERIAL

- Chalky Vintage Look, 250 ml,
Aqua / Aqua Art. 1196 703 50
- Koralle / Coral Art. 1196 210 50
- Petrol / Petrol Art. 1196 706 50
- Clear Stamps „Ahoi“ Nr. 4003 160 00
- Pinsel, flach, Größe 10, Art. 9300 110 00
Brush, flat, size 10, Art. 9300 110 00
- Pinsel, spitz, Größe 2, Art. 9300 162 00
Brush, pointed, size 2, Art. 9300 162 00
- Magnete / magnets
- Heißklebepistole / Hot glue gun
- altes Messer / old knife

ca. 200g für
6 Magnetpins

approx. 200g for 6 magnet pins

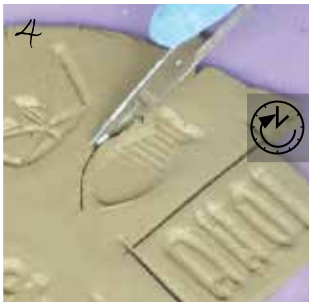

PINN' DIR DEINE IDEEN

Pin your ideas





ZUSÄTZLICHES MATERIAL

ADDITIONAL MATERIAL

- Keramik Effekt, 150 ml, Art. 1185 100 48
Ceramic-effect, 150 ml, Art. 1185 100 48
- Modellier-Werkzeug, 6-tlg., Art. 9302 137 00
Modeling Tool Set, 6 pieces, Art. 9302 137 00
- Pinsel, flach, Größe 10, Art. 9300 110 00
Brush, flat, size 10, Art. 9300 110 00
- schwarzer Filzstift / black felt pen
- Schleifpapier, Körnung 150, Art. 9300 917 00
Sanding Paper, 150 grit, Art. 9300 917 00

ca. 700g
 3/4 für Körper + 1/4 für Kopf mit Ohren
3/4 for the body + 1/4 for the head and ears

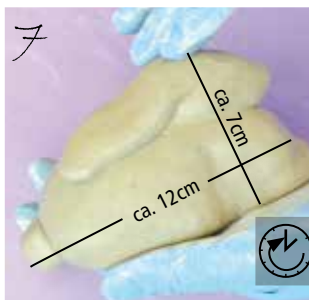
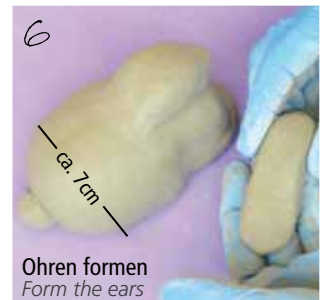

SOMEBUNNY LOVES YOU

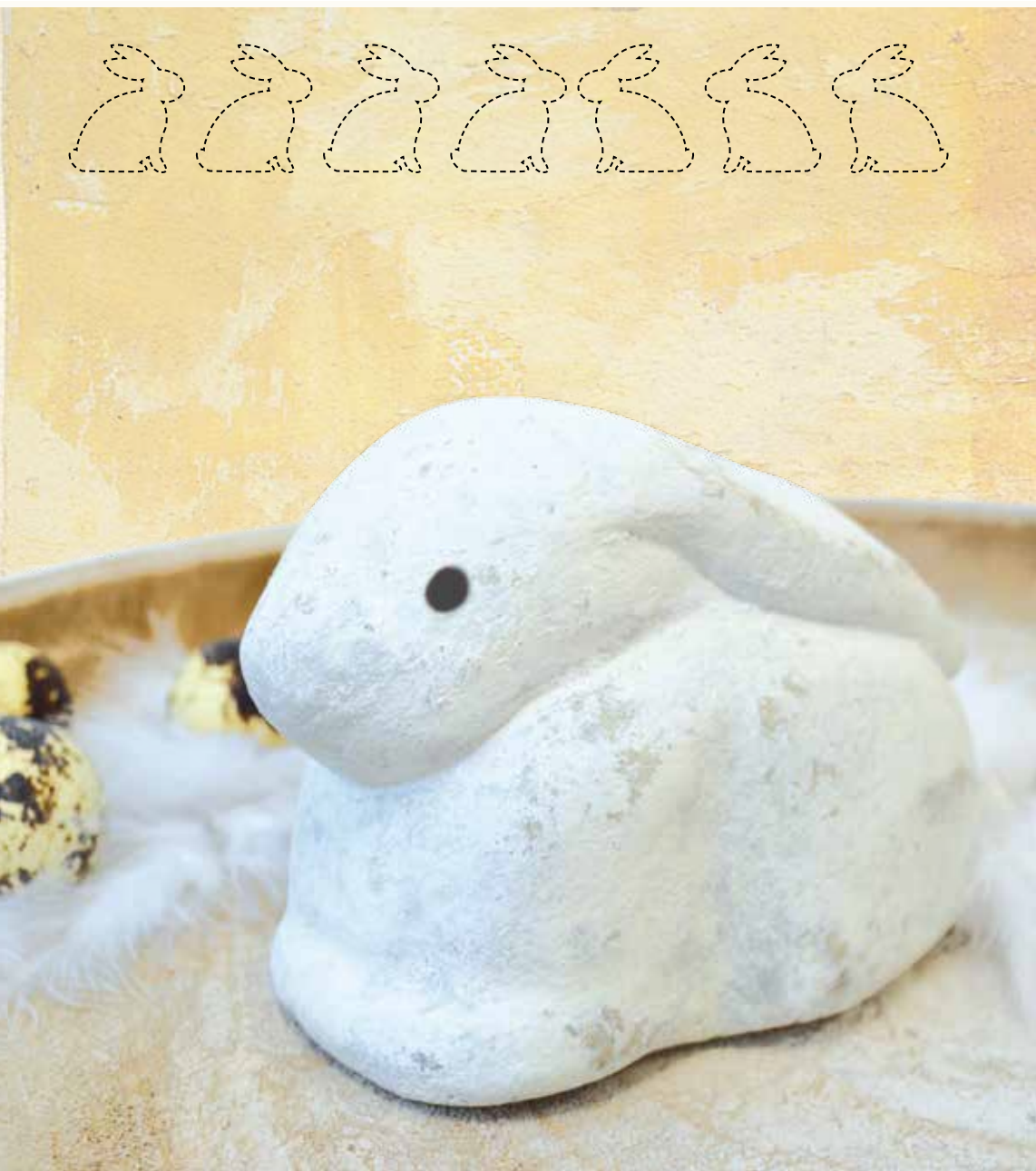



ZUSÄTZLICHES MATERIAL

ADDITIONAL MATERIAL

- Chalky Vintage Look, 250 ml, Umbra / Umber Art. 1196 452 50
- Keramik Effekt, 150 ml, Art. 1185 100 48
Ceramic-effect, 150 ml, Art. 1185 100 48
- Styroporkugeln 8, 10 + 15cm / styrofoam balls
- Nagel / nail
- Pinsel, flach, Größe 10, Art. 9300 110 00
Brush, flat, size 10, Art. 9300 110 00
- Kreativ-Schwämmchen eckig / Creative Sponge Square
- Paketschnur / Package cord
- altes Messer / old knife

ca. 550g (mittlerer Kürbis)
 (medium pumpkin)

ca. 350g (kleiner Kürbis)
 (small pumpkin)

ca. 900g (großer Kürbis)
 (big pumpkin)



ca. 10 min.

ORANGE war gestern

Orange was yesterday



trocknen
drying





ZUSÄTZLICHES MATERIAL

ADDITIONAL MATERIAL

- Multi-Color, 90ml,
Klassisch Rot / Red Art. 1223 404 11
- Keramik Effekt, 150 ml, Art. 1185 100 48
Ceramic-effect, 150 ml, Art. 1185 100 48
- Modellier-Werkzeug, 6-tlg., Art. 9302 137 00
Modeling Tool Set, 6 pieces, Art. 9302 137 00
- Styroporkugel / styrofoam ball
- Pinsel, flach, Größe 10, Art. 9300 110 00
Brush, flat, size 10, Art. 9300 110 00
- Nagel / nail
- künstlicher Bart / artificial beard

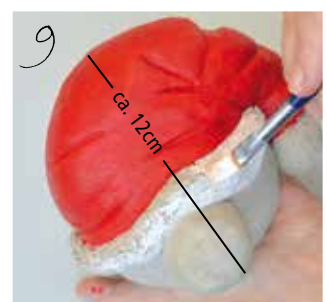
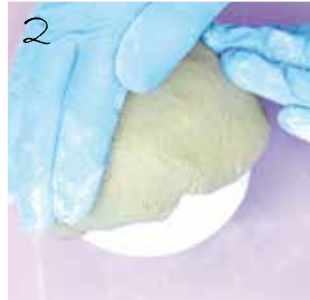
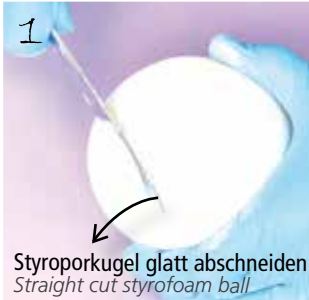

ES WAR EINMAL...

...ein Weihnachtswichtel

Once upon a time...there was a Christmas gnome





ZUSÄTZLICHES MATERIAL

ADDITIONAL MATERIAL

- Plastikschüssel / Plastic Bowl
- Keramik Effekt, 150 ml, Art. 1185 100 48
Ceramic-effect, 150 ml, Art. 1185 100 48
- Maya-Gold Gold / Gold Art. 1232 902 34
- Pinsel, flach, Größe 10, Art. 9300 110 00
Brush, flat, size 10, Art. 9300 110 00
- Pinsel, spitz, Größe 2, Art. 9300 162 00
- Holzsterne in versch. Größen
wooden stars in different sizes



Nur für Dekorationszwecke, nicht lebensmittelecht
Only for decoration, not food safe



WEISST DU WIEVIEL Sternlein STEHEN...?

Do you know how many stars are there?



∅ ca. 15 cm



ZUSÄTZLICHES MATERIAL

ADDITIONAL MATERIAL

- Acrylkugel / Acrylic Bowl
- Keramik Effekt, 150 ml, Art. 1185 100 48
Ceramic-effect, 150 ml, Art. 1185 100 48
- Maya-Gold Gold / Gold Art. 1232 902 34
- Pinsel, flach, Größe 10, Art. 9300 110 00
Brush, flat, size 10, Art. 9300 110 00
- Pinsel, spitz, Größe 2, Art. 9300 162 00
Brush, pointed, size 2, Art. 9300 162 00
- Holzsterne in versch. Größen / wooden stars in different sizes
- Schleifpapier, Körnung 150, Art. 9300 917 00
Sanding Paper, 150 grit, Art. 9300 917 00

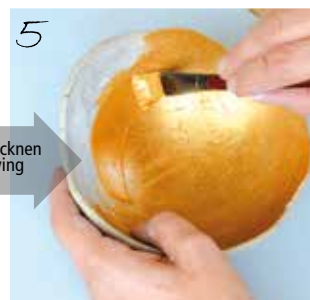
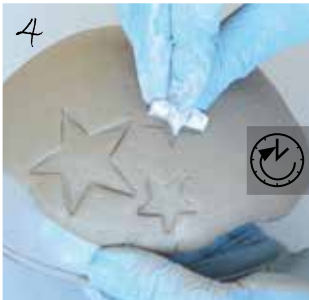

ZEIT FÜR Sternenglanz

Time for starlights





Viva Decor GmbH
 Meierweg 8
 D-32108 Bad Salzuflen

0049 (0) 52 22 / 3 63 36-0
www.viva-decor.de
info@viva-decor.de



Ihr Viva Decor Fachhändler:



Art.Nr.: 9013 258 00

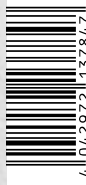

Vertrieb ausschließlich über den Fachhandel
 Druckfehler u. Änderungen vorbehalten, Farbabweichungen
 sind drucktechnisch bedingt

*Distribution exclusively through specialized trade only
 Misprints and subject to alteration, 100% color accuracy can not be
 guaranteed due to printing techniques*